

ASSEMBLY INSTRUCTIONS AND PARTS LIST FOR SEED HOPPER AND SUPPORT STAND

ASSEMBLY INSTRUCTIONS

The seed hopper is designed to regulate the flow of seeds from the discharge spout of super sacks into the hopper of various conveyors.

1. Mount the hopper, Item 1A, to the two horizontal support angles, Items 2. Use the two center holes in the vertical leg of each support angle.

NOTE: All connections use a 3/8" x 1" long hex head bolt and locknut.

2. Bolt a vertical leg angle, Item 3, and a leg gusset plate, Item 4, to the end of each horizontal support angle, Item 2.

NOTE: The vertical leg angle should mount on the inside of the horizontal support angle with the gusset plate sandwiched in between the vertical leg and the horizontal support.

3. Repeat step 2 for the other three vertical leg angles.
4. Connect an end panel, item 5, to two of the vertical leg angles, Items 3, on one end of the support stand.

NOTE: The holes used depends on the height of the hopper desired. See typical applications shown.

5. Repeat step 4 for the other end of the support stand.

PARTS LIST

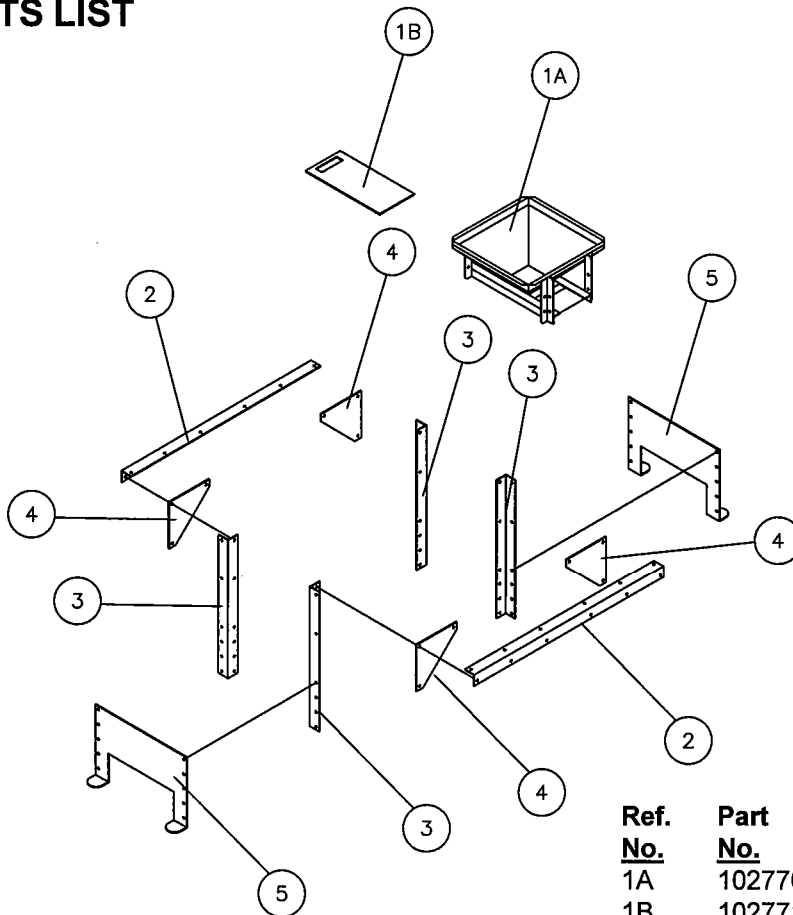

Ref. No.	Part No.	Description
1A	1027704	Hopper Weldment
1B	1027710	Slide Gate
2	1027955	Horizontal Support Angle
3	1027954	Vertical Leg Angle
4	1027953	Leg Gusset Plate
5	1027952	End Panel

ASSEMBLY INSTRUCTIONS AND PARTS LIST FOR SEED HOPPER AND SUPPORT STAND

Page 2

TYPICAL ARRANGEMENTS

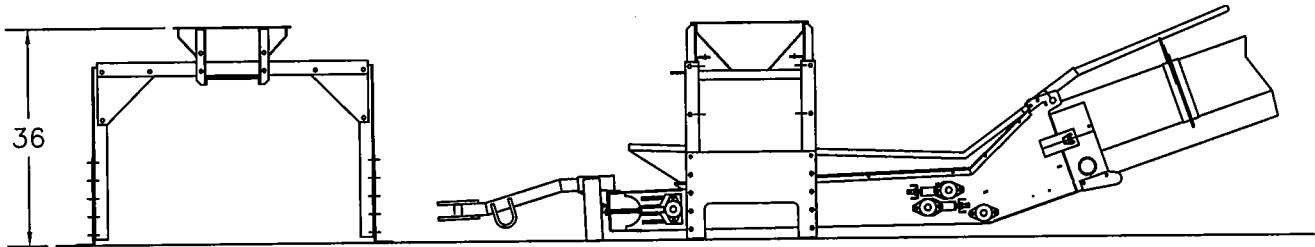

SHOWN ON SEED BELT APPLICATION

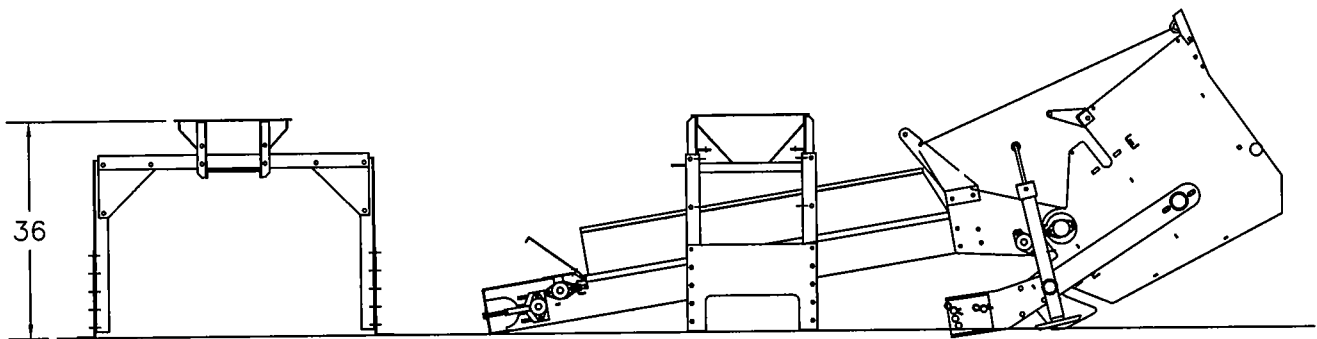

SHOWN ON SQUEEZE BELT APPLICATION

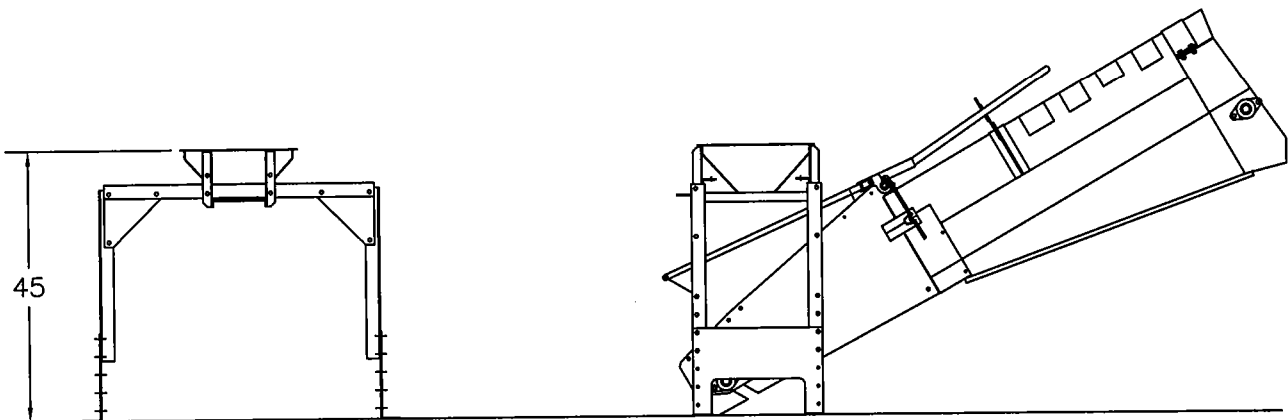

SHOWN ON SINGLE BELT APPLICATION