

Hutchinson/Mayrath ASSEMBLY INSTRUCTIONS

The following instructions are to be used for assistance with the set-up and installation of equipment, accessories, and serviceable parts used on this machinery and are not meant to replace any operating or safety procedures as outlined in the Operator's Manual included with the auger.



This safety symbol is used throughout these instructions to alert you to information about unsafe actions or situations, and will be followed by the word DANGER, WARNING, or CAUTION. Be Alert! Your safety and the safety of others is involved.

DANGER - Indicates immediate hazards that may result in severe injury or death. **WARNING** - Indicates unsafe actions or situations that may cause severe injury, death and/or major equipment or property damage. **CAUTION** - Indicates unsafe actions or situations that may cause injury, and/or minor equipment or property damage.

CASTER END WHEEL KIT, PART NO. 10151W for use with the TRANSFER BELT CONVEYORS B1015H & HB1015H



WARNING! Do Not rely solely on hydraulic and mechanical jacks or overhead hoist for support. Use appropriate jack stands or equivalent for supporting the unit.

Install Caster Wheels

1. Raise the hitch end of the conveyor high enough off the ground to allow the caster wheels to be installed. Support the conveyor using appropriate support stands or equivalent.

2. Caster wheel height can be adjusted to fit your particular application. Position a caster wheel on the end of the conveyor and determine which adjustment hole will be used for installation.

Install the caster mounts to each side of the conveyor as shown in Fig. 1. Secure each caster mount using one (1) 5/8" x 5" bolt, lock washer and non-lock nut.

3. Install each swivel caster wheel to the mounts using four (4) 3/8" x 1" bolts, flat washers, lock washers and non-lock nuts (See Fig. 1).

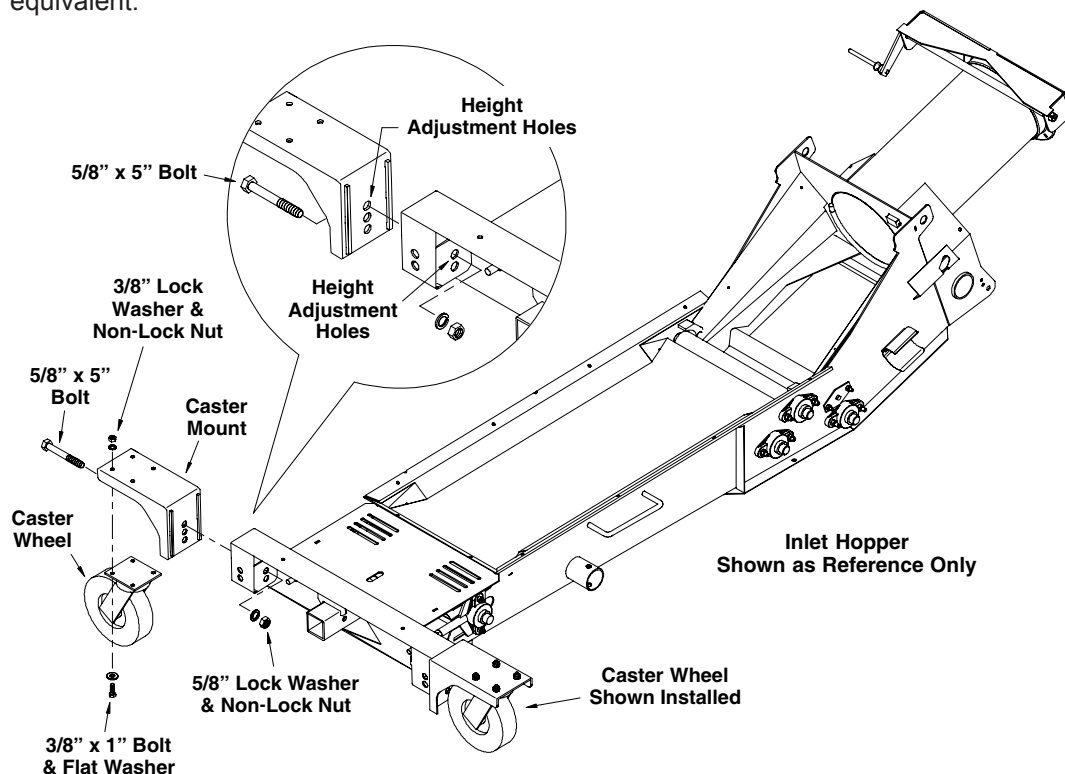

PARTS LIST

CASTER WHEEL KIT, PART NO. 10151W

This Caster Kit can be used on both the B1015H (Mayrath Transfer Belt Conveyor's)
and the HB1015H (Hutchinson Transfer Belt Conveyor's).

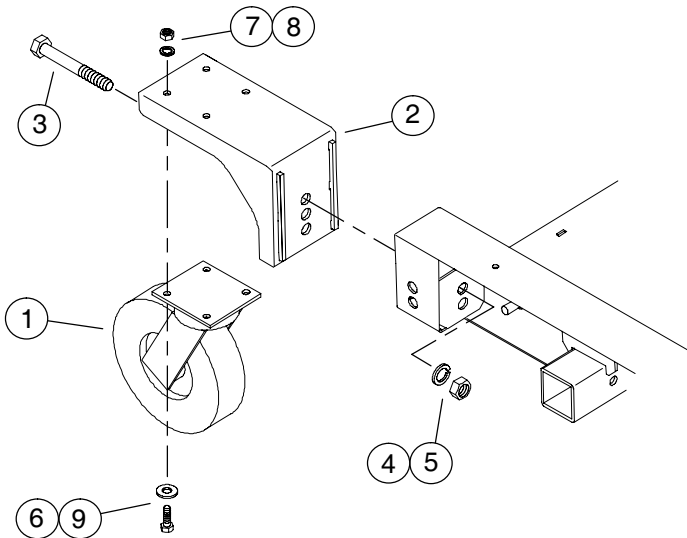

Ref. No.	Part No.	Description
1	1001499	Caster, Swivel Wheel
2	1031669	Mount, Caster Wheel
3	1004711	Bolt, 5/8-11 x 5" G5 PLT
4	D1170	Nut, 5/8-11 Non-Lock PLT
5	D1171	Washer, 5/8" Lock PLT
6	33060	Bolt, 3/8-16 x 1" G5 PLT
7	D1149	Nut, 3/8-16 Non-Lock PLT
8	D1150	Washer, 3/8" Lock PLT
9	33024	Washer, 3/8" Flat PLT

Where Used Bolt List

Part	Description	Qty.	Where Used
1004711	Bolt, 5/8-11 x 5" G5 PLT	2	Caster Mount to Conveyor
D1171	Washer, Lock 5/8" PLT	2	
D1170	Nut, Non-lock 5/8-11 PLT	2	
33060	Bolt, 3/8-16 x 1" G5 PLT	8	Caster Wheel to Caster Mount
D1150	Washer, Lock 3/8" PLT	8	
D1149	Nut, Non-lock 3/8-16 PLT	8	
33024	Washer, Flat 3/8" PLT	8	